

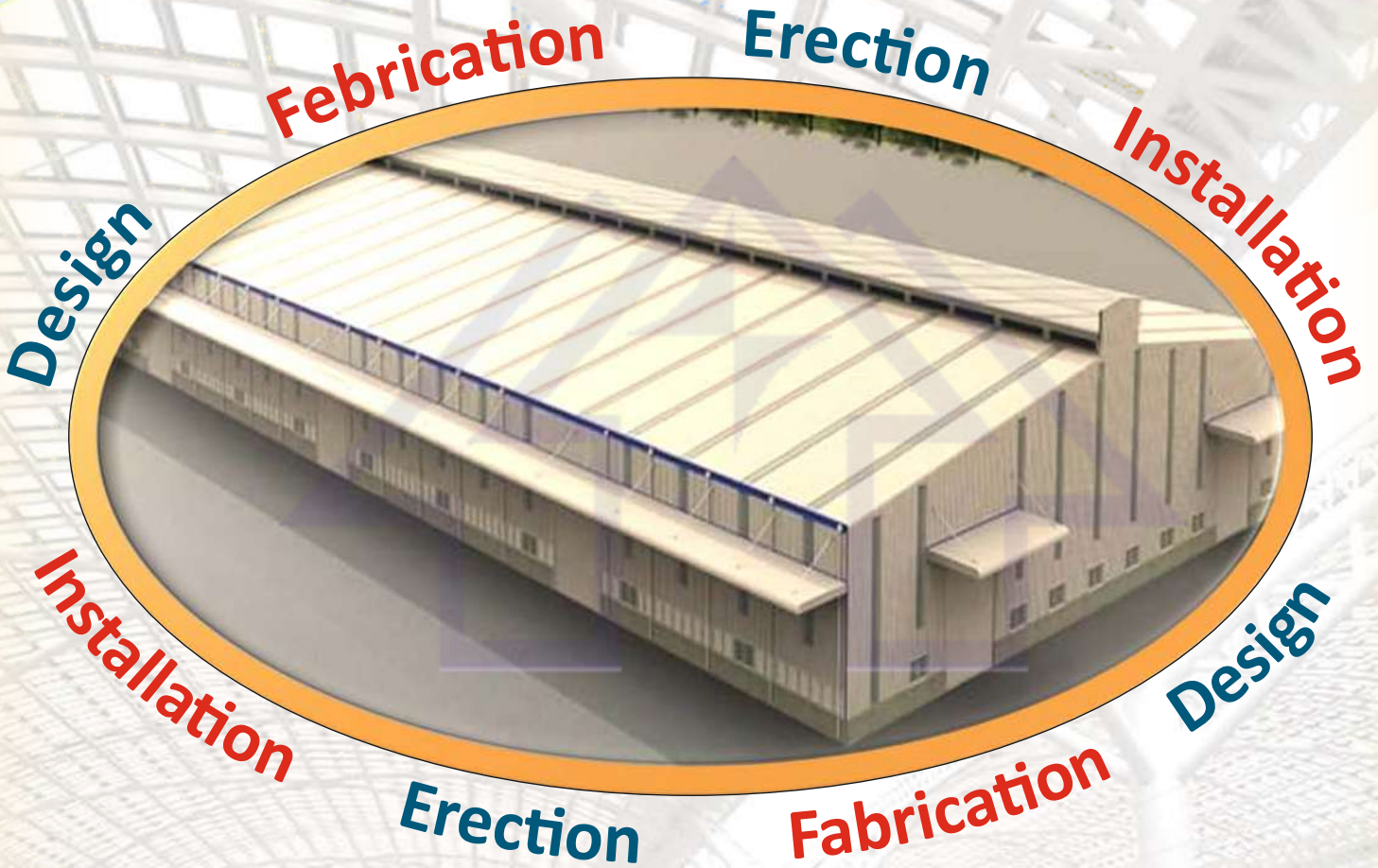

A Complete solution for roofing

DEZIRE STRUCTURES



inquiry.dezire@gmail.com
dezireroofing@gmail.com



Hemant Mishale
+91 9689519554
+91 7498891117



A Complete solution for roofing

INTRODUCTION

DEZIRE STRUCTURES is one of India's fastest growing building solutions company. Following a solutions approach where various products & services are integrated to meet customer's needs. Dezire Structures offers a complete range like roofing, ceilings, walls, floors, cladding, doors, & Pre-engineered Steel Buildings for industrial, commercial & Residential Sectors

Today Dezire Structures is one of the most respected and renowned business entities in India & has gained a strong foothold in the market. Dezire Structures have the strength of over highly qualified employees & experienced designers, technicians and fabricators.

PRE -ENGINEERED BUILDING COMPONENTS

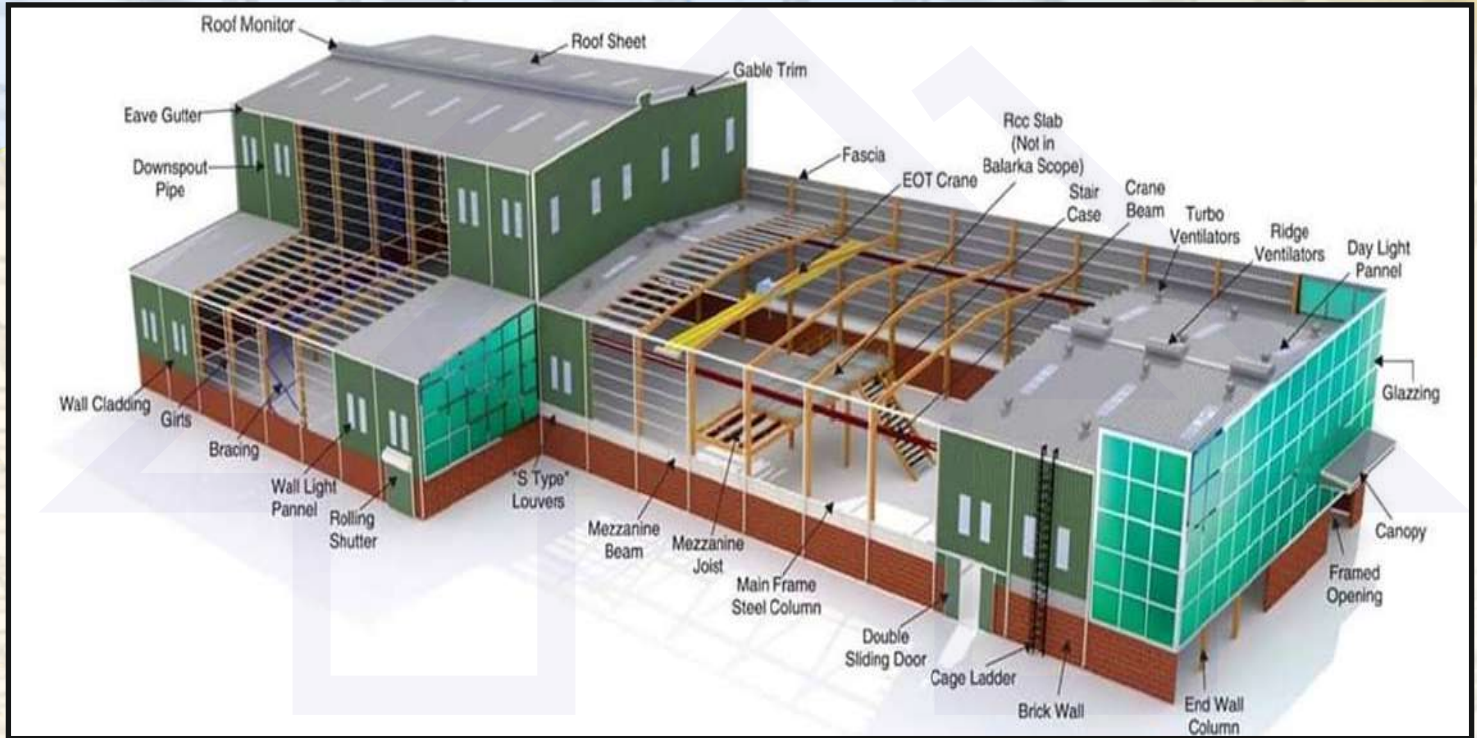

- A Pre-Engineered Buildings (PEBs) is a steel shell utilizing three distinct product categories:
- Built-up "I" shaped primary structural framing members (columns and rafters).
- Cold-formed "Z" and "C" shaped secondary structural members (roof purlins, eave struts and wall girts).
- Roll formed profiled sheeting (roof and wall panels).

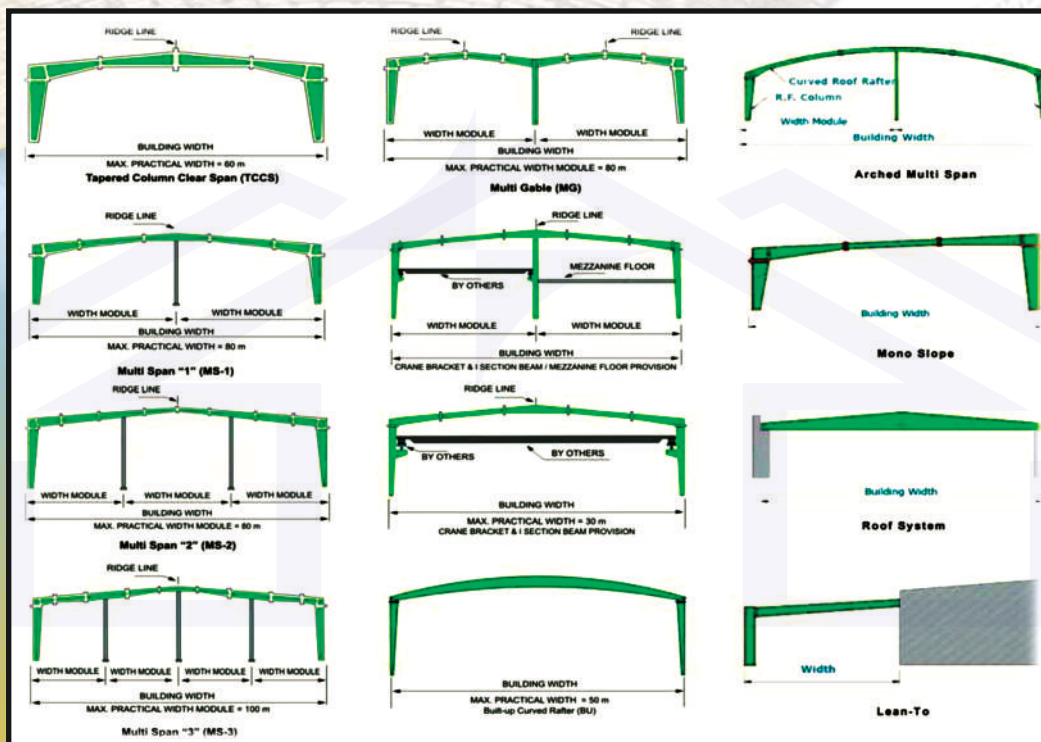

APPLICATION :

- Industrial Building
- Prefabricated Steel Structure
- Tubular Steel structure
- Commercial Building,
- Sports Complexes
- Factory Sheds
- Warehouse
- Canopies
- School Building



Primary Members:

Primary structural framing shall include the transverse rigid frames, lean-to-rafters and columns, canopy rafters, interior columns (beam and column frames), bearing frame rafters and corner columns and end wall wind columns.

Secondary Members:

Secondary structural framing shall include the purlins, girts eavestruts, wind bracing, flange bracing, base angles, clips and other miscellaneous structural parts.

Paint :

All structural members shall be cleaned by wire brushing to remove dirt, grease, oil and loose mill scale and given one shop coat of red oxide, air drying. Any additional finish painting is not included in Dezire Structures scope.

Connections :

- All field connections shall be bolted.
- Primary bolted connections shall be furnished with high strength bolts confirming to the physical specifications of ASTM 325 (or equivalent).
- Secondary bolted connections shall be furnished with machine bolts confirming to the physical specifications of ASTM 3207 (or equivalent).

Physical Specifications Of Structural Members :

- Members fabricated from plates shall have flanges and webs joined on one side of the web by submerged welding process having a minimum yield strength 345 mpa.
- Members fabricated by cold forming process shall have a minimum yield strength of 345 mpa
- Members fabricated from hot rolled structural shapes shall have a minimum Yield strength of 250 mpa.
 - Rod and angle bracing shall have a minimum yield strength of 250 mpa.
- Roof and wall cladding shall confirm to physical specifications have a minimum Yield strength of 345 mpa.
- All other miscellaneous secondary members have a minimum yield strength of 250 mpa.

Roof Sheeting / Wall Sheeting :

Roof and wall panels shall be of 26 gauges thick profiled galvalume / galvalume color coated / gi colour coated steel sheeting. In case of prepainted galvalume panels, the exterior face is prepainted galvalume panels, the exterior face is prepainted with 1 mil. thick factory applied polyester paint. The interior face is prepainted with 0.5 mil. thick factory applied polyester paints. each panel shall be white / grey. Other materials, thickness and coating are available upon request.

Sheeting Fasteners :

Standard fasteners shall be self tapping sheet metal screws with metal and neoprene washers. All screws shall have hexagonal heads.

Flashing and Trim

- Flashing and / or trim shall be furnished at the rake, corners, and eaves framed openings and wherever necessary to provide weather tightness and finished appearance
- Eave gutters shall be box shaped, colour coated, 0.5mm nominal thickness (26 gauge) galvanized steel. The outside face of the gutter shall be supported with colour coated 0.5mm nominal thickness (26 gauge) straps to the eave member at a maximum spacing Of 0.2 m

Profile Sheet

PPGL (Aluminum Zinc Base)
Per - painted Galvalume Roofing Sheets
(55% Aluminum - Zinc Alloy)

Specification:

Aluminum - Zinc Coating : AZ 150 / 70
Paint Thickness (Top): 18-10 Microns
Paint Coat: RMP (Regular Modified Polyester)
Paint Thickness (Bottom): 5-8 Microns
Surface Finish: Glossy (Matt Finish Optional)
Tensile Strength: 345-550 Mpa

PPGI (Zinc Base)

Per Painted Galvanized
Roofing Sheet

Specification:

Zinc Coating: 120 GSM
Paint thickness (Top): 18-10 microns
Paint Coat: RMP (Regular Modified Polyester)
Paint ``): 5-8 Microns
Surface Finish: Glossy (Metal Finish Optional)

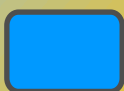

Light Blue

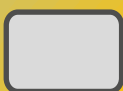

Off White

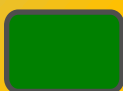

Misty Green



Brick Red



Bare Galvalume

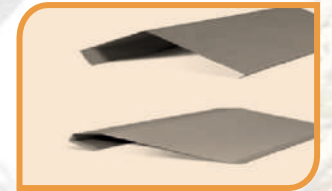

1000 Dezire Profile (Hicover)

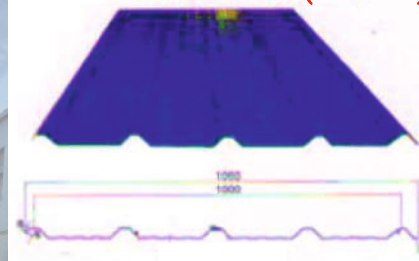

ACCESSORIES ROOFING MATERIAL :

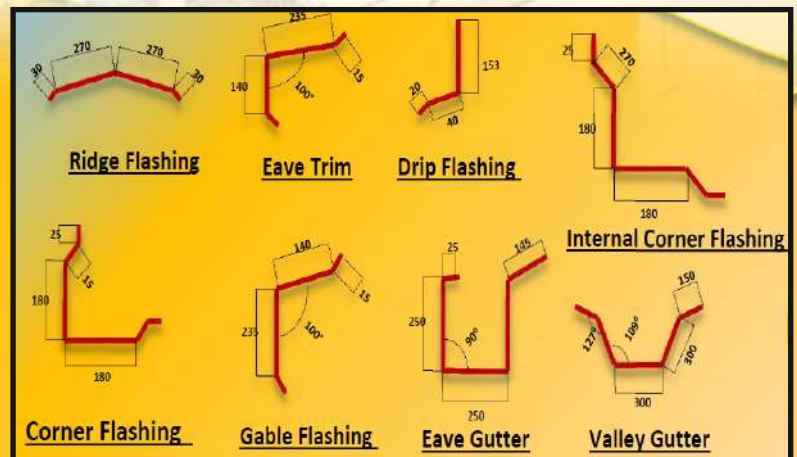



A Complete solution for roofing

OUR RANGE OF PRODUCTS INCLUDE

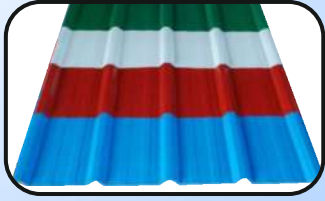

ROOF SHEET



DECK SHEET



CLIP - LOCK SHEET

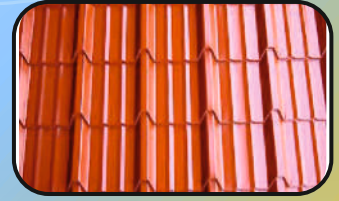

ROOF TILE SHEET

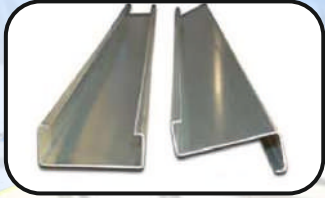

PURLIN Z / C

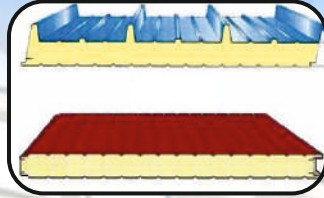

PUFF ROOFING & WALL SHEET



TURBO FAN

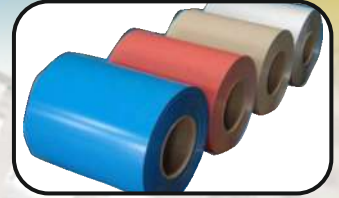

SHEET COIL



INSULATION



PIPE SECTION



NUT BOLTS



FOUNDATION BOLTS

OUR SITE PROJECTS

